

# LV FUSE CLIPS BOARD MOUNT



**NEW**

Part Number	Holder	Fuse Type	Blade Width	Rating	Orientation	Mounting Method
FC-MINV	Clip	Mini Blade	2.8mm	15A	Vertical	Thru Hole
FC-MINH	Clip	Mini Blade	2.8mm	15A	Horizontal	Thru Hole
FC-ATOV	Clip	Auto Blade	5.2mm	15A	Vertical	Thru Hole
FC-ATOH	Clip	Auto Blade	5.2mm	15A	Horizontal	Thru Hole
FC-MAXV	Clip	Maxi Blade	8.3mm	50A	Vertical	Thru Hole
FCB-26	Board	Mini Blade	2.8mm	15A	Vertical	Thru Hole
FCB-25	Board	Auto Blade	5.2mm	20A	Vertical	Thru Hole

**Material:** Tin plated spring brass.  
**Pack Size:** Varies, please contact sales.  
**Note Clips:** 2pcs required per fuse.  
**Data Sheet:** Contact sales

**Approvals:**



**Mini Fuse Board THM**



**Auto Fuse Board THM**



**Mini Clips Vertical**



**Mini Clips Horizontal**



**Auto Clip Vertical**



**Auto Clips Horizontal**



**Maxi Clips Vertical**

# AUTO FUSE HOLDER BOARD MOUNT



Part Number	Mounting Type	Description
00420	Thru Hole	Fuse holder
00359	Clip On	Clear cover

**Rating:** 15A **Voltage:** 32V  
**Body:** Black PA66, UL94 V2.  
**Mounting:** Thru Hole Mount.  
**Cover:** Transparent PC  
**Terminals:** Tin plated phosphor bronze, Inox-steel clip included.  
**Feature:** Stackable end or side.  
**Pack Size:** 5, 10, 100, 500, 1000  
**Notes:** Auto fuse is not included.

**Mounting Pattern**

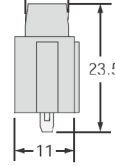
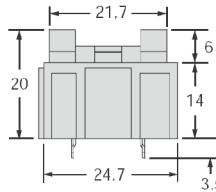
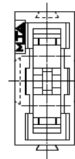
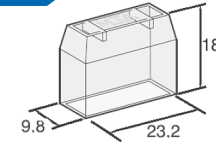

Dimensions in MM

**RELATED PRODUCTS:** **Auto Fuse** (see p.17)



# EV CARTRIDGE FUSE CLIPS 10.3MM DIAMETER



Part Number	Mounting Type
BC800	Thru Hole

**Rating:** 32A **Voltage:** 250V-1500V  
**Clip Material:** Brass, Tin plated.  
**Pack Size (bag):** 2, 10, 100, 1000  
**Feature:** Fuse end stop  
**Suits EV Cartridge Fuse:** 10.3 x 38.1mm.  
**Approvals:**

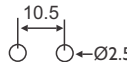

**Mounting Pattern**

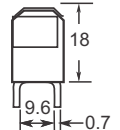
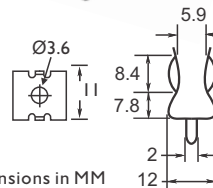

Dimensions in MM

**RELATED PRODUCTS:** **EV Cartridge Fuses** (see p.32 -34)

