

## LIGHT DUTY BATTERY FEEDER STUDS 1/4"

**GEP**  
POWER PRODUCTS

**NEW**  
**58V**  
**MIL-STD**

### Features

- Small and light application through a firewall or bulkhead.
- High rating in a small package Military Grade.
- High torque rating due to patented material combination.

Part Number	Stud	Hardware	Colour
PTR-14D-05	1/4"-28	Serrated Flange Nuts	Red ■
PTB-14D-05	1/4"-28	Serrated Flange Nuts	Black ■
OR-022	-	O-Ring Seal	Black ■

**Voltage:** 58VDC **Rating:** 400A (0 AWG or larger wire).

**Grade:** Commercial & Military

**Torque Rating:** Body-Locknut 10 foot lbs.

**Materials:** Body-Nylon 66, Conductive-Core-Copper.

**Studs:** Stainless Steel.

**Mounting Locknut:** 1.25" Nylon 66. **Option:** Steel.

**Hardware:** 2 x Serrated Flange Nut-Zinc Plated Steel.

**O-Ring Material:** Silicon **Size:** AS568-022

**O-Ring Seal Dimensions:** Cross Section: 1.59mm  
Internal Dia. 25.4mm, Outside Dia. 28.58mm.

**Note:** No Caps. RoHS



**Panel Cutout**  
Ø 22.1mm



**O-Ring Seal**



1/4"-28 Stud

Pass Thru

Mounting Nut

Serrated  
Flange Nut

**Overall Dimensions:**  
58 H x 36 W x 32 D (mm)

## HEAVY DUTY BATTERY FEEDER STUDS 3/8"

**GEP**  
POWER PRODUCTS

**NEW**  
**58V**  
**MIL-STD**

### Features

- Military grade, power feed for applications through a firewall or bulkhead.
- Higher electrical rating and lower resistance due to a larger cross sectional area and the utilization of a higher conductive material.
- Increased installation torque values GEP's unique manufacturing.

Part Number	Stud	Hardware	Mtg Nut	Caps	Colour
PTR-38A-01	3/8"-16	Double Nuts SS	Stainless	Yes	Red ■
PTB-38A-01	3/8"-16	Double Nuts SS	Stainless	Yes	Black ■
PTR-38A-02	3/8"-16	Double Nuts SS	Nylon	Yes	Red ■
PTB-38A-02	3/8"-16	Double Nuts SS	Nylon	Yes	Black ■
PTR-38A-05	3/8"-16	Flange Nuts SS	Nylon	No	Red ■
PTB-38A-05	3/8"-16	Flange Nuts SS	Nylon	No	Black ■
C14-1003	N/A	Seal O-ring Blk	Nylon	-	Black ■
SC10-2000A-B008	N/A	Seal Nut Red	Nylon	-	Red ■
SC10-2000A-B001	N/A	Seal Nut Blk	Nylon	-	Black ■

**Voltage:** 58VDC

**Rating:** 400A (2/0 or larger wire).

**Torque Rating:** Body-Locknut 10 foot lbs.

**Body:** Nylon 66,

**Conductive Core:** 110 Copper.

**Studs:** Stainless Steel (SS).

**Grade:** Commercial & Military.

**Mounting Nut & Hardware:** See above.

**Options:** Custom configuration, contact sales.

**O-Ring Seal**

Ø 38.2

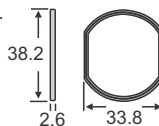

**Panel Cutout**

Ø 33.4

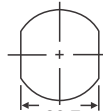

3/8"-16 Stud

Pass Thru

IP67 Seal Nut

Mounting Nut

Double Nut

Stud Cap

**Overall Dimensions:**  
84H x 57 W x 49 D  
Dimension in MM

### RELATED PRODUCTS:



**O-Ring Seal**  
IP67 Black



**Seal Nut**  
IP67 Red



**Seal Nut**  
IP67 Black



**Flange**  
Nut



Scan this  
QR Code  
for more  
information



QR Code: 9053