

Designed to meet multiple power / ground requirements, these blocks provide 3 pass-thru M6 studs for easy cable attachment in both the cabin and engine compartment of your vehicle. They provide robust connections, eliminates the need to stack cables and reduces associated warranty claims based on affiliated problems. Perfect for many power feed thru applications including marine, construction, agriculture, bus, military, RV and specialty vehicles. The GB3000 blocks include 2 removable bus bars when fitted create a common single circuit (ground) across the 3 feed thru studs. The GB3001 blocks do not include bus bars and therefore provide 3 independent feed thru power circuits.

Part Number	Block Description	Current Rating	Body Colour
GB3000-1R	1 Circuit Feed Thru	200A Max Total	Red
GB3000-1B	1 Circuit Feed Thru	200A Max Total	Black
GB3001-1R	3 Circuit Feed Thru	60A Max Per	Red
GB3001-1B	3 Circuit Feed Thru	Stud	Black



GB3000-1R



GB3000-1B

Temperature Rating: -40°C to 85°C

Hardware: M6 nuts included.

Torque: M6 stud & mounting 5.6Nm max.

Current Carrying Studs: Zinc-plated brass.

Mounting Studs: Stainless steel.

Housing: Black UL rated 94V0 thermoplastic.

Cover Material: Santoprene cover rated 94V0 for protection from accidental shorts.

Gasket: Included for ingress protection.

Black santoprene gasket rated 94V0.

Approvals: RoHS

1 Circuit Feed Thru
GB3000



3 Circuit Feed Thru
GB3001

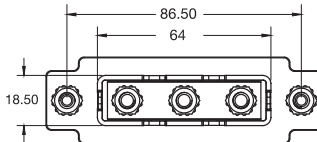

Pictured Without Cover

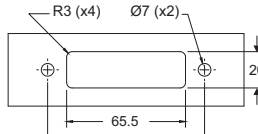

Panel Cutout

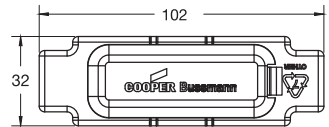
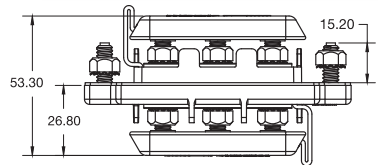

Dimensions in MM