

# STUD TYPE JUNCTION BLOCKS - FEED THROUGH

**Bussmann**

Feed-Through blocks are designed to be used on a firewall or panel.

Part Number	Body Colour	Amp Rating	Thread Size M	Stud Mat.	Stud Plating
C1925B	Black	400A	1/2"-13	Brass	Zinc
C1925	Red	400A	1/2"-13	Brass	Zinc
C1925-1B	Black	400A	1/2"-13	Brass	Tin
C1925-1	Red	400A	1/2"-13	Brass	Tin
C1925-2B	Black	250A	3/8"-16	Brass	Tin
C1925-2	Red	250A	3/8"-16	Brass	Tin

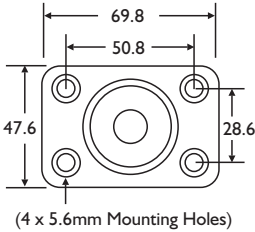

Dimensions in MM

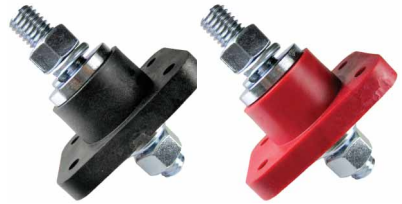
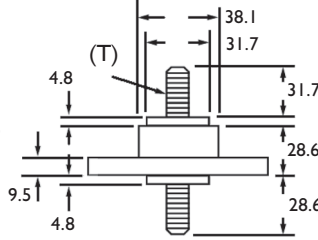

**C1925B**  
1/2"-13 Stud

**C1925**  
1/2"-13 Stud



**C1925-2B**  
3/8"-16 Stud

**C1925-2**  
3/8"-16 Stud

Part Number	Body Colour	Amp Rating	Thread Size M	Stud Mat.	Stud Plating	Diagram
C1938-I	Black	200A	5/16"-18	Brass	Tin	1
C1938-1R	Red	200A	5/16"-18	Brass	Tin	1
C1938	Black	250A	3/8"-16	Brass	Zinc	1
C1938R	Red	250A	3/8"-16	Brass	Zinc	1
C2791	Black	100A	1/4"-20	Brass	Zinc	2
C2791-R	Red	100A	1/4"-20	Brass	Zinc	2

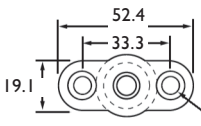

Dimensions in MM

**Diagram 1**

Mounting Holes  
(2 x 5.6mm)

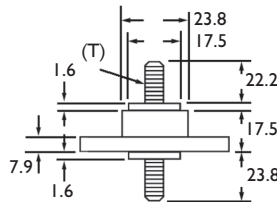

**C1938-I**  
5/16"-18 Stud

**C1938-1R**  
5/16"-18 Stud



**C1938**  
3/8"-16 Stud

**C1938R**  
3/8"-16 Stud

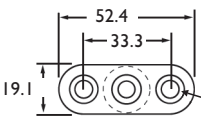

Dimensions in MM

**Diagram 2**

Mounting Holes  
(2 x 5.6mm)

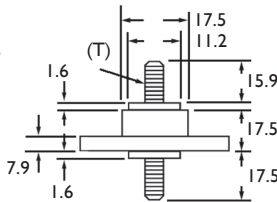

**C2791**  
1/4"-20 Stud

**C2791-R**  
1/4"-20 Stud

**Voltage:** AC / DC

**Body:** Thermoplastic

**Studs:** Brass

**Mounting Torque Rating:** Contact sales.

**Hardware:** Hex nut & spring washer supplied in bulk.  
Also available without hardware.